

MS7

FEATURES

- ※PC board terminals option
- ※13.3x5.3x7.2mm
- ※Variety of lever options
- ※Sealed IPX7.

APPLICATION

- ※Automotive industry
- ※Household appliances
- ※Vacuum cleaner

SPECIFICATION

Contact Rating	2A at 12VDC/1A at 24VDC
Mechanical Durability	1,000,000 cycles MIN.
Electrical Durability	100,000 cycles MIN.
Contact Resistance	100mΩ MAX.
Insulation Resistance	100MΩ MIN. (at 500VDC)
Dielectric Strength	Between terminals of the same polarity: 600VAC(50Hz or 60Hz) shall be applied across terminals for 1 minute
	Between each terminal and ground: 1500VAC(50Hz or 60Hz) shall be applied across terminals for 1 minute
Operating Temp.	-40°C ~ +85°C

HOW TO ORDER

M S 7 - □ □ □ □ □ □ □ □

Rating:
2=12VDC 2A
24VDC 1A

Actuator:
P=Pin Plunger
L3=Long Hinge Leaf Lever
S4=Simulated Roller Leaf Lever
S5=Simulated Roller Lever
L7=Long Hinge Lever

Contact Form:
1=SPDT
2=SPST-NC(Molded Lead Wire Models Only)
3=SPST-NO(Molded Lead Wire Models Only)

V=RoHS & Lead Free
Plating:
G=Silver Plating
Terminal:
W=Solder Terminal
N=Solder Terminal Non Holes
H=PCB Terminal
L1=PCB Terminal (Left-angled)
W2=Molded Wire On Right-Side
W3=Molded Wire On Left-Side
W4=Molded Wire Downward
Posts:
A=Without Posts
BJ=Long Posts on Left
BK=Long Posts on Right
EJ=Short Posts on Left
EK=Short Posts on Right
C=M3-Screw Mounting Models

CIRCUIT

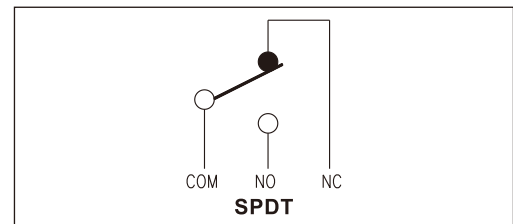

Pin Plunger

MS7 - □ **P** □ □ □ □ □ □ □ □

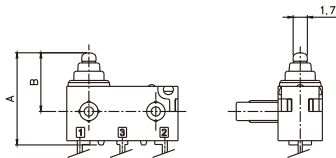

WITHOUT POST(A)	MODELES WITH POST(B)	M3-SCREW MOUNTING MODELS(B)
11.2mm MAX.	7.2mm MAX.	

Simulated Roller Leaf Lever

MS7 - □ **S4** □ □ □ □ □ □ □ □

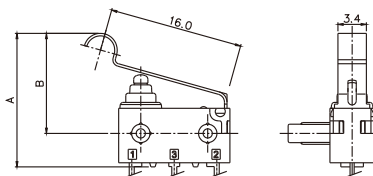

WITHOUT POST(A)	MODELES WITH POST(B)	M3-SCREW MOUNTING MODELS(B)
17.0mm MAX.	13.0mm MAX.	

Simulated Roller Lever

MS7 - □ **S5** □ □ □ □ □ □ □ □

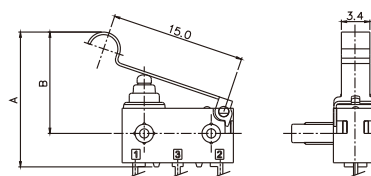

WITHOUT POST(A)	MODELES WITH POST(B)	M3-SCREW MOUNTING MODELS(B)
16.5mm MAX.	12.5mm MAX.	

Long Hinge Leaf Lever

MS7 - □ **L3** □ □ □ □ □ □ □ □

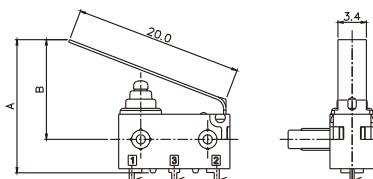

WITHOUT POST(A)	MODELES WITH POST(B)	M3-SCREW MOUNTING MODELS(B)
15.9mm MAX.	11.9mm MAX.	

Long Hinge Lever

MS7 - □ **L7** □ □ □ □ □ □ □ □

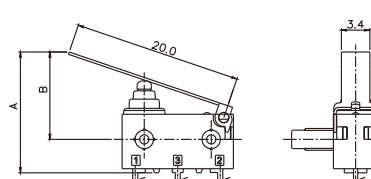

WITHOUT POST(A)	MODELES WITH POST(B)	M3-SCREW MOUNTING MODELS(B)
15.5mm MAX.	11.5mm MAX.	

Contact Form:

SPDT

MS7 - **1**

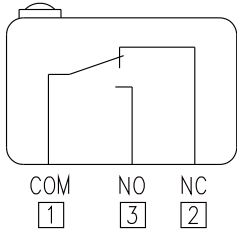

Contact Form:

SPST-NC(Molded Lead Wire Models Only)

MS7 - **2**

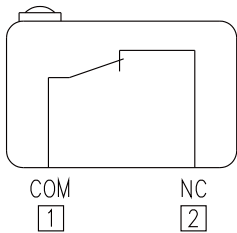

Contact Form:

SPST-NO(Molded Lead Wire Models Only)

MS7 - **3**

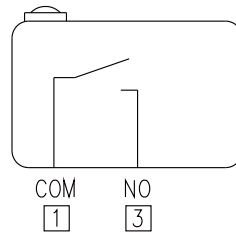

Posts:

Without Posts

MS7 - **A**

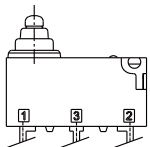
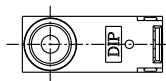

Posts:

M3-Screw Mounting Models

MS7 - **C**

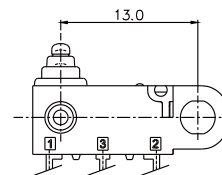
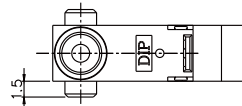

Posts on Left

MS7 - **J**

PART NO.	LENGTH(L)
BJ	5.0
EJ	1.5

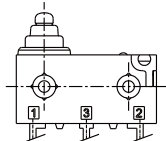
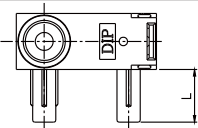

Posts on Right

MS7 - **K**

PART NO.	LENGTH(L)
BK	5.0
EK	1.5

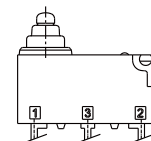
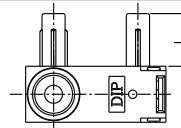

MICRO SWITCH MS7 SERIES

Terminal:

Solder Terminal

MS7 - □□□□W□□

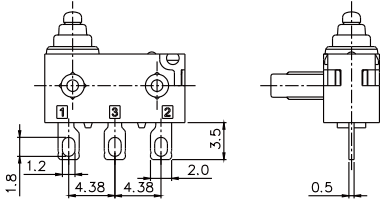

Solder Terminal Nomholes

MS7 - □□□□N□□

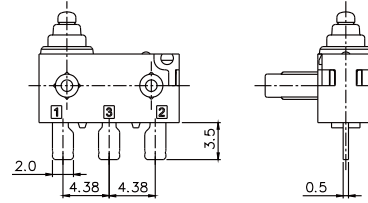

PCB Terminal

MS7 - □□□□H□□

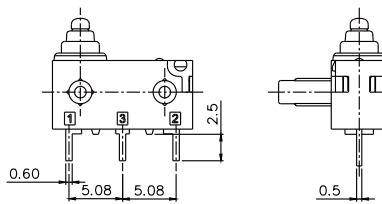

PCB Terminal(Left Angled)

MS7 - □□□□L1□□

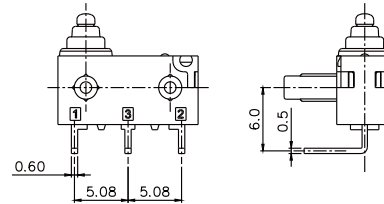

W2=Molded Wire On Right-Side

MS7 - □□□□W2□□

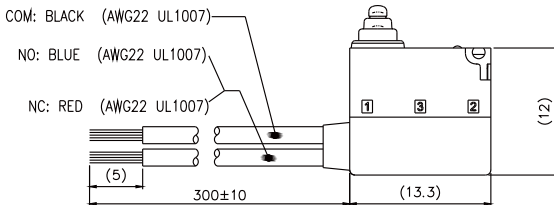
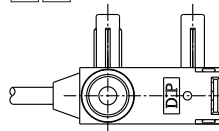

W3=Molded Wire On Left-Side

MS7 - □□□□W3□□

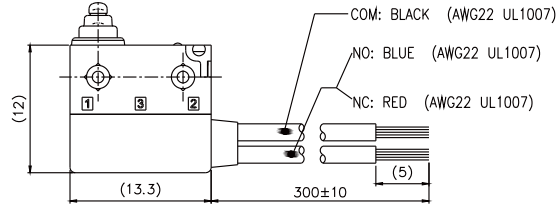
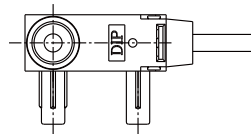

W4=Molded Wire Downward

MS7 - □□□□W4□□

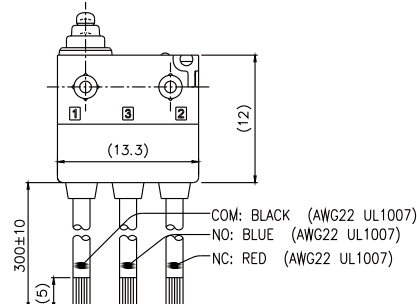
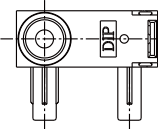

MS7-2P1_HGV

OPERATING CHARACTERISTICS

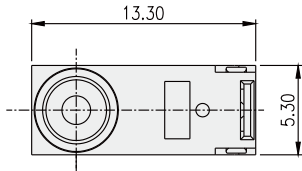

TYPE	WITHOUT POSTS	MODELES WITH POSTS	M3-SCREW MOUNTING MODELS
ITEM	SPEC.		
OPERATING FORCE(OF)	75gf(0.75N) MAX.		
RELEASE FORCE(RF)	10gf(0.10N) MIN.		
OVERTRAVEL(OT)	1.4mm MIN.(Reference)		
MOVEMENT DIFFERENTIAL(MD)	0.25mm MAX.		
FREE POSITION(FP)	11.2mm MAX.	7.2mm MAX.	
OPERATING POSITION(OP)	10.4±0.2mm	6.4±0.2mm	
TOTAL TRAVEL POSITION(TTP)	9.1mm MAX.	5.1mm MAX.	

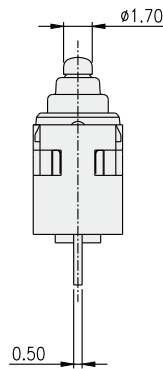
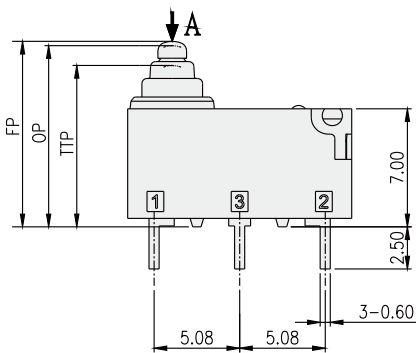

MS7-2S41_WGV

OPERATING CHARACTERISTICS

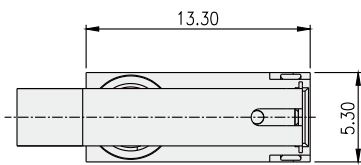

TYPE	WITHOUT POSTS	MODELES WITH POSTS	M3-SCREW MOUNTING MODELS
ITEM	SPEC.		
OPERATING FORCE(OF)	183gf(1.80N) MAX.		
RELEASE FORCE(RF)	20gf(0.20N) MIN.		
OVERTRAVEL(OT)	2.0mm MIN.(Reference)		
MOVEMENT DIFFERENTIAL(MD)	0.5mm MAX.		
FREE POSITION(FP)	17.0mm MAX.	13.0mm MAX.	
OPERATING POSITION(OP)	14.8±0.5mm	10.8±0.5mm	
TOTAL TRAVEL POSITION(TTP)	12.9mm MAX.	8.9mm MAX.	

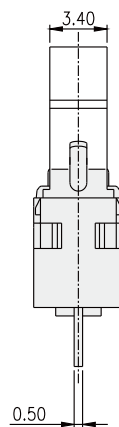
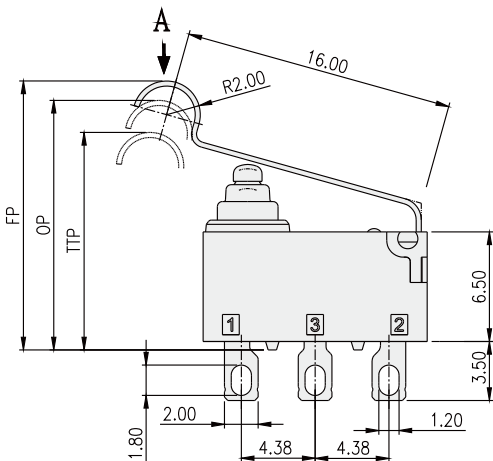

MS7-2L31_HGV

OPERATING CHARACTERISTICS

TYPE	WITHOUT POSTS	MODELES WITH POSTS	M3-SCREW MOUNTING MODELS
ITEM	SPEC.		
OPERATING FORCE(OF)	122gf(1.20N) MAX.		
RELEASE FORCE(RF)	5gf(0.05N) MIN.		
OVERTRAVEL(OT)	2.5mm MIN.(Reference)		
MOVEMENT DIFFERENTIAL(MD)	0.7mm MAX.		
FREE POSITION(FP)	15.9mm MAX.	11.9mm MAX.	
OPERATING POSITION(OP)	12.1±0.8mm	8.1±0.8mm	
TOTAL TRAVEL POSITION(TTP)	10.0mm MAX.	6.0mm MAX.	

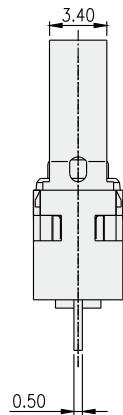
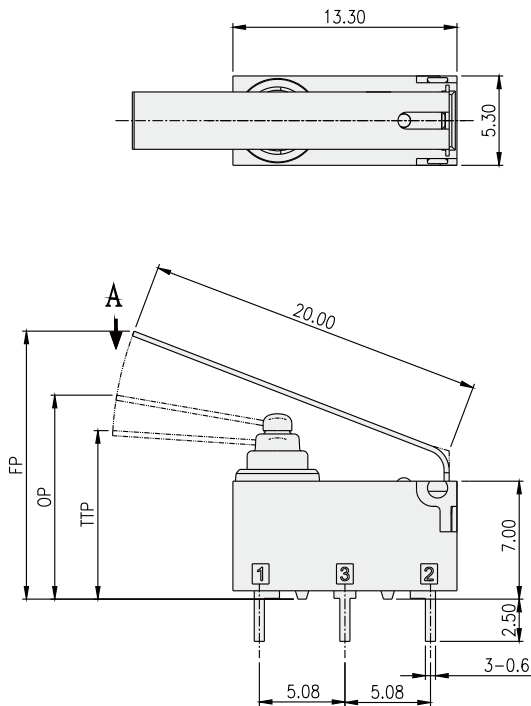

MS7-2S51_HGV

OPERATING CHARACTERISTICS

TYPE	WITHOUT POSTS	MODELES WITH POSTS	M3-SCREW MOUNTING MODELS
ITEM	SPEC.		
OPERATING FORCE(OF)	66gf(0.65N) MAX.		
RELEASE FORCE(RF)	5gf(0.05N) MIN.		
OVERTRAVEL(OT)	1.9mm MIN.(Reference)		
MOVEMENT DIFFERENTIAL(MD)	0.5mm MAX.		
FREE POSITION(FP)	16.5mm MAX.	12.5mm MAX.	
OPERATING POSITION(OP)	15.2±0.5mm	11.2±0.5mm	
TOTAL TRAVEL POSITION(TTP)	13.5mm MAX.	9.5mm MAX.	

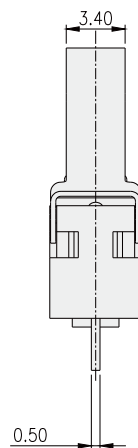
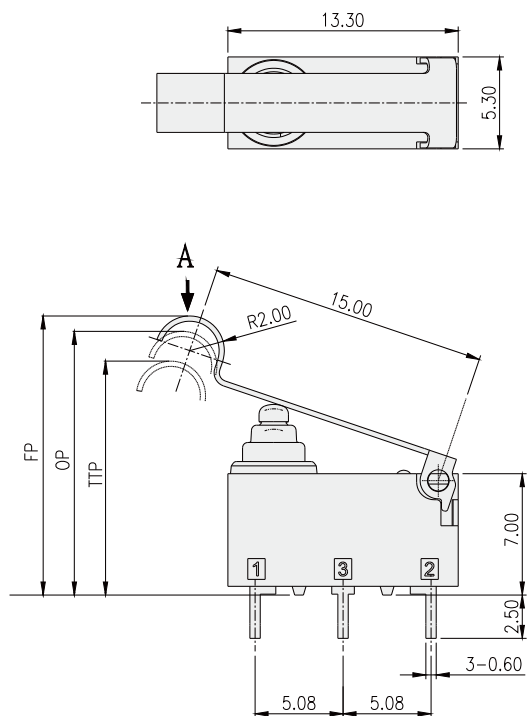

MS7-2L71_WGV

OPERATING CHARACTERISTICS

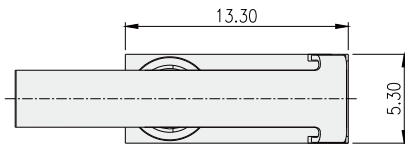

TYPE	WITHOUT POSTS	MODELES WITH POSTS	M3-SCREW MOUNTING MODELS
ITEM	SPEC.		
OPERATING FORCE(OF)	50gf(0.50N) MAX.		
RELEASE FORCE(RF)	3gf(0.03N) MIN.		
OVERTRAVEL(OT)	2.5mm MIN.(Reference)		
MOVEMENT DIFFERENTIAL(MD)	0.8mm MAX.		
FREE POSITION(FP)	15.5mm MAX.	11.5mm MAX.	
OPERATING POSITION(OP)	13.3±0.8mm	9.3±0.8mm	
TOTAL TRAVEL POSITION(TTP)	11.0mm MAX.	7.0mm MAX.	

