

TBEG

FEATURES

- ※Electrical life: 200,000 cycles
- ※Sharp click feeling
- ※2.7x3.0mm miniature tact switch

APPLICATION

- ※Automotive
- ※Video game device

SPECIFICATION

| | |
|-----------------------|----------------------------|
| Contact Rating | 50mA, 12V DC |
| Contact Resistance | 100mΩ max. |
| Insulation Resistance | 100MΩ min. 500V DC |
| Dielectric Strength | 250V AC/1 minute |
| Operating Force | 160±50gf/200±50gf/400±80gf |
| Travel | 0.12mm |
| Operating Life | 200,000 cycles |
| Operating Temp. | -40°C ~ +85°C |
| Storage Temp. | -40°C ~ +90°C |

HOW TO ORDER

T B E - - Q -

G=With Ground Pin
=Without Ground Pin

Package:
T/R=Tape & Reel

Halogen Free

Operating Force:
N=Brown, 160gf
W=White, 200gf
=Black, 400gf

CIRCUIT

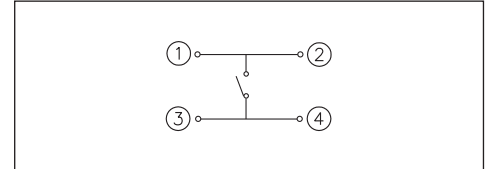

PACKAGE

<Tape & Reel>
8000 pcs

TACT SWITCH

TBE

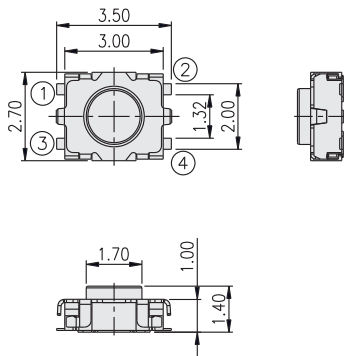

P.C.B. LAYOUT

TBEG

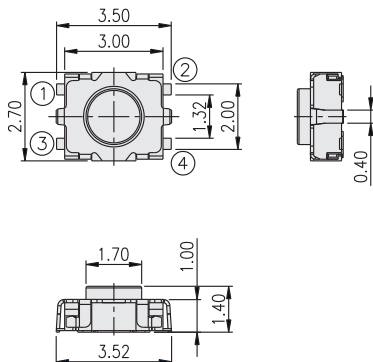

P.C.B. LAYOUT