

TACT SWITCH
T1A SERIES

2.8*1.9 SMT Type
(H=0.60mm)

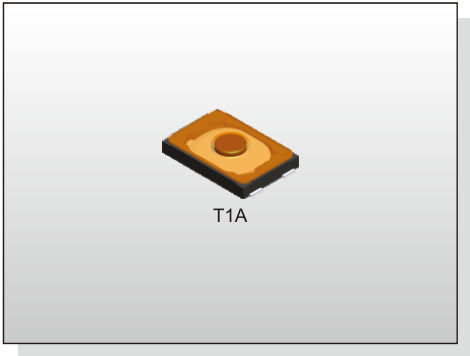

FEATURES

- ※ Compact-size 2.8*1.9mm
- ※ Low profile with 0.60mm
- ※ Long operating cycles

APPLICATION

- ※ Smart phone
- ※ Digital camera, Medical
- ※ Portable electronic device
- ※ 3C products

SPECIFICATION

Contact Rating	10uA, 1V DC to 50mA, 12V DC
Contact Resistance	500mΩ max.
Insulation Resistance	100MΩ min. 100V DC
Dielectric Strength	100V AC/1 minute
Operating Force	160±50gf / 200±50gf
Travel	0.13mm
Operating Life	300,000 cycles
Operating Temp.	-40°C ~ +85°C
Storage Temp.	-40°C ~ +85°C

HOW TO ORDER

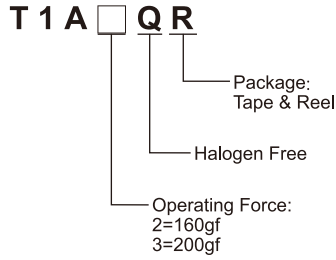

CIRCUIT

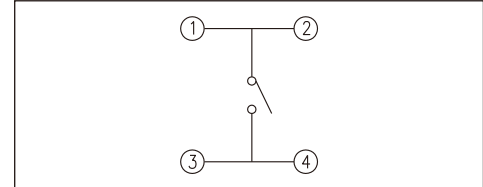

PACKAGE

<Tape & Reel>
16000 pcs

TACT SWITCH

T1A

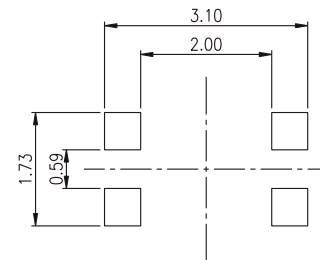
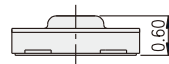
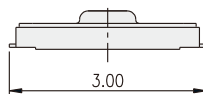
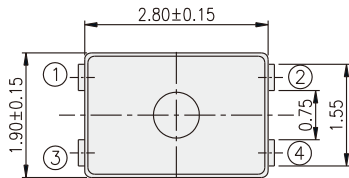

P.C.B. LAYOUT