

# DIP SWITCH NDA SERIES

## Right Angle Type

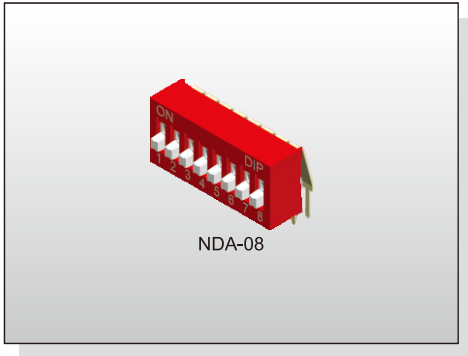

### FEATURES

- ✦ Side actuation
- ✦ Gold contact for high reliability
- ✦ Red, blue, and black color options.

### APPLICATION

- ✦ Industrial control
- ✦ Computers and peripherals
- ✦ Variety of function controls

### SPECIFICATION

Contact Rating	25mA, 24V DC
Contact Resistance	50mΩ max.
Insulation Resistance	100MΩ min. 500V DC
Dielectric Strength	500V AC/1 minute
Operating Force	1,000gf max.
Travel	2mm
Operating Life	2,000 cycles
Operating Temp.	-40°C ~ +85°C
Storage Temp.	-40°C ~ +85°C

### CIRCUIT

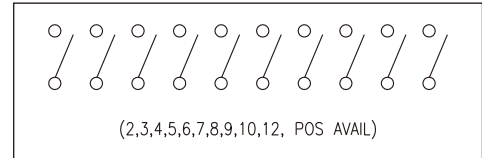

### PACKAGE

#### <Tube>

NDA-02: 73pcs	NDA-02T: 70 pcs
NDA-03: 52pcs	NDA-03T: 50 pcs
NDA-04: 40pcs	NDA-04T: 39 pcs
NDA-05: 33pcs	NDA-05T: 32 pcs
NDA-06: 28pcs	NDA-06T: 28 pcs
NDA-07: 24pcs	NDA-07T: 24 pcs
NDA-08: 21pcs	NDA-08T: 21 pcs
NDA-09: 19pcs	NDA-09T: 19 pcs
NDA-10: 17pcs	NDA-10T: 17 pcs
NDA-12: 14pcs	NDA-12T: 14 pcs

DIP SWITCH

### HOW TO ORDER

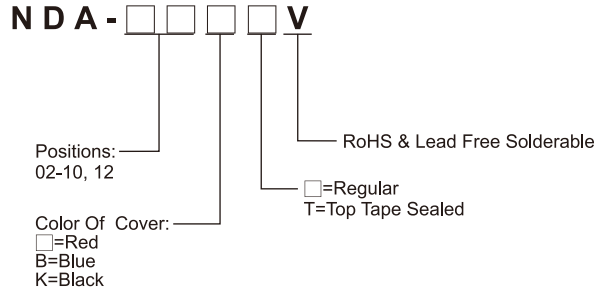

## NDA

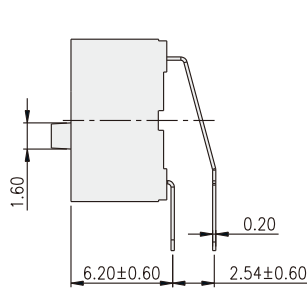
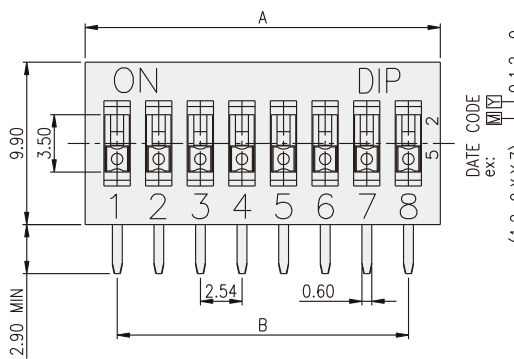
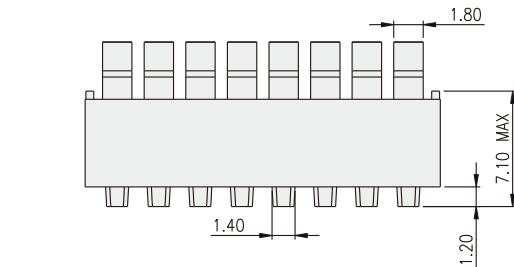

PART NO.	NO. OF POS.	DIM.A	DIM.B
NDA-02	2	6.44	2.54
NDA-03	3	8.98	5.08
NDA-04	4	11.52	7.62
NDA-05	5	14.06	10.16
NDA-06	6	16.60	12.70
NDA-07	7	19.14	15.24
NDA-08	8	21.68	17.78
NDA-09	9	24.22	20.32
NDA-10	10	26.76	22.86
NDA-12	12	31.84	27.94

