

ILLUMINATED SWITCH ZPBL SERIES

Pushbutton Switches Illuminated

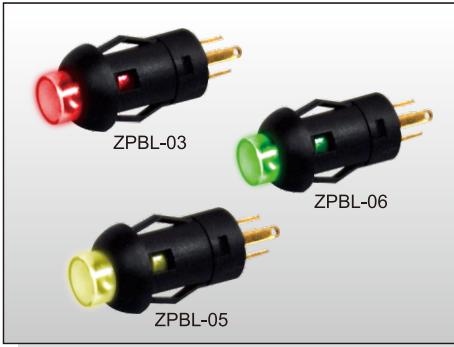

FEATURES

- ✘ Small size
- ✘ Long electrical life
- ✘ High brightness LED. Button surface are illuminated and even

APPLICATION

- ✘ Automotive industry
- ✘ Office appliance
- ✘ Computer products
- ✘ Communication equipments
- ✘ Audio equipment

SPECIFICATION

Contact Rating	0.1A, 30V DC
Contact Resistance	50mΩ max. 1.5V DC; 100mA, by Method of Voltage DROP
Insulation Resistance	100MΩ min. 500V DC
Dielectric Strength	500V AC/1 minute
Operating Force	250±100gf
Travel	1.2mm
Operating Life	50, 000 cycles
Operating Temp.	-40°C ~ +85°C

HOW TO ORDER

Z P B L -

Led Color:
01=White
03=Red
05=Yellow
06=Green
07=Blue
76=Blue(Green)

WITH LED ELECTRO-OPTICAL DATA

Lens Appearance	Color	Electro-optical Data(AT 20mA)				Peak Wavelength	Viewing Angle 2θ 1/2(deg)
		Vf(V)		Iv(mcd)			
		Typ.	Max.	Typ.	Min.		
Water Clear	White	3.3	4	1500	900	X/Y=0.31	45°
	Red	1.95	2.5	1300	700	630	
	Yellow	2.1	2.5	25	12	588	
	Green	2.1	2.5	300	100	570	
	Blue	3.3	4	1300	700	470	
	Blue(Green)	B	3.3	4	160	80	470
	G	2.1	2.5	80	30	570	

CIRCUIT

Single LED

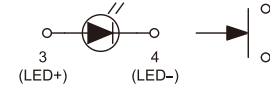

Dual Colors LED

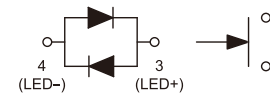

PACKAGE

<Bag>
100 pcs.

ZPBL-XX

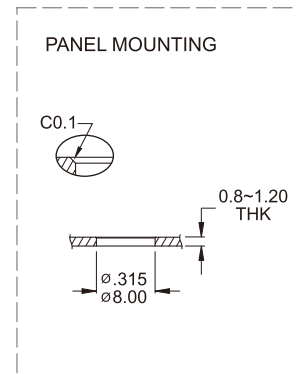
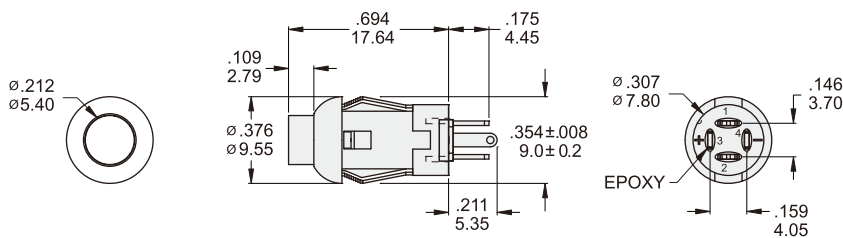

ZPBL-A2

